



RACORES INDUSTRIALES

- ✓ INDUSTRIA ALIMENTARIA
- ✓ CAMLOCK AISI 316 – DIN 2828
- ✓ RACORES BAJA PRESIÓN 150LBS AISI304

► **Casquillos para prensar** | Jupes à sertir | Crimp ferrules | Boccole a pressare

155



81042

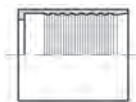

81050

► **Racores SMS** | Raccords SMS | SMS Unions | Raccordi SMS

156

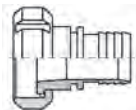

ZRA200

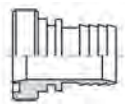

ZRA212



ZSMS H



ZRA500

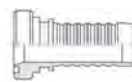

ZRA512



ZSMS S



ZSMS M



JSMSS



JSMSP

► **Racores Tri-Clamp** | Raccords Tri-Clamp | Clamp Unions | Raccordi Tri-Clamp

157



ZTC



ZC

► **Racores DIN 11851** | Raccords DIN 11851 | DIN 11851 Unions | Raccordi DIN 11851

158

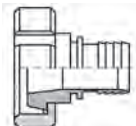

ZRA100

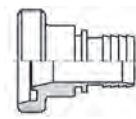

ZRA112



ZDIN H



ZRA400



ZRA412



ZDIN S



ZDIN M

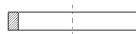

JDINS

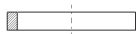

JDINP

► **Racores Macon** | Raccords Macon | Macon Unions | Raccordi Macon

159

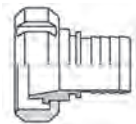

ZRA300

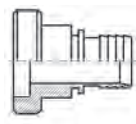

ZRA312



ZMAC H

Camlock AISI 316 - DIN 2828

Raccords Camlock AISI 316 - DIN 2828 | Camlock AISI 316 - DIN 2828 | Camlock AISI 316 - DIN 2828

Racores Camlock AISI 316 | Raccords Camlock AISI 316 | Camlock Unions AISI 316 | Raccordi Camlock AISI 316

160

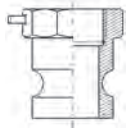

ZA



ZB

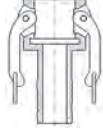

ZC



ZD



ZE



ZF

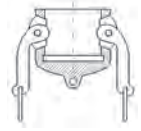

ZDC



ZDP

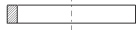

JCAMNBR

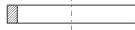

JCAMS

Crimp fittings for hoses

Pipe fittings DIN 2353

Flare fittings J/C SAE flanges

Adaptors

Welding fittings

Industrial fittings

Several items

Racores baja presión 150 LBS AISI 304

Raccords basse pression 150 LBS AISI 304 | Screwed fittings low pressure 150 LBS AISI 304 | Raccordi bassa pressione 150 LBS AISI 304

Racores baja presión 150 LBS AISI 304 | Adapteurs basse pression 150 LBS AISI 304 | Screwed fittings low pressure 150 LBS AISI 304 | Raccordi bassa pressione AISI 304

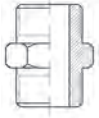

ZFIG280



ZFIG301

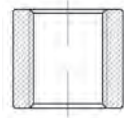

ZFIG270

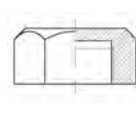

ZFIG300

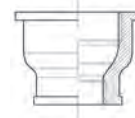

ZFIG240

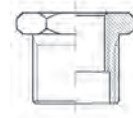

ZFIG241



ZFIG090

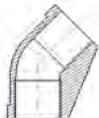

ZFIG120

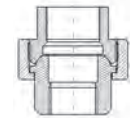

ZFIG340

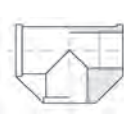

ZFIG130



ZFIG092

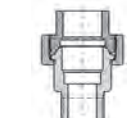

ZFIG341



ZFIG290



ZFIG180



ZFIG291

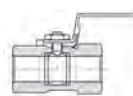

BP2V



BP2V3P

Crimp fittings for hoses

Pipe fittings DIN 2353

Flare fittings JIC
SAE flanges

Adaptors

Welding fittings

Industrial fittings

Several items

Casquillos para mangueras alimentarias



Jupes à sertir tuyaux alimentaires
Food hoses ferrules
Boccola a pressare per tubi alimentari

DN	Ø ext	REFERENCIA PART N°	€
13-1/2"	23	810421324	
19-3/4"	32	810421933	
25-1"	39	810422540	
32-1"1/4	48	810423248	
38-1"1/2	52	810423852	
38-1"1/2	56	810423857	
40-1"1/2	54	810424055	
40-1"1/2	60	810424061	
50-2"	63	810425064	
50-2"	68	810425069	
50-2"	73	810425073	
65-2"1/2	79	810426580	
65-2"1/2	93	810426593	
70-3"	89	810427090	
75-3"	94	810427595	
75-3"	106	8104275107	
100-4"	122	81042100123	
100-4"	134	81042100135	

**Casquillos Teflón
coarrugado para racores
alimentarios**

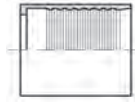

Jupes Teflon convoluté pour raccords alimentaires
Convoluté PTFE ferrules for food fittings
Boccola a pressare Teflon coarrugato per raccordi alimentari

DN	REFERENCIA PART N°	€
1"	810501600	
1" 1/4	810502000	
1" 1/2	810502400	
2"	810503200	

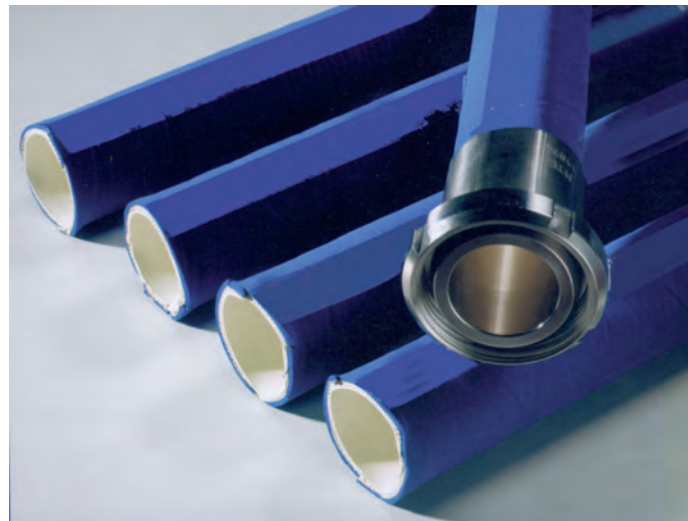

Hembras giratorias SMS

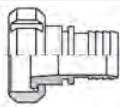

Raccord femelle tournante SMS

Swivel female SMS

Femmina girevole SMS

DN	ROSCA THREAD	REFERENCIA PART N°	€
25	40x1/6	ZRA2004025	
32	48x1/6	ZRA2004832	
38	60x1/6	ZRA2006038	
40	60x1/6	ZRA2006040	
50	70x1/6	ZRA2007050	
65	85x1/6	ZRA2008565	
70	98x1/6	ZRA2009870	
75	98x1/6	ZRA2009875	
80	98x1/6	ZRA2009880	
100	125x1/4	ZRA200125100	
100	132x1/4	ZRA200132100	

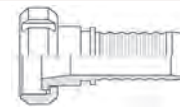
Hembra giratoria
preisar SMS para Teflón
coarugado

Femelle tournante SMS pour Teflon convoluté

Swivel female SMS pur convoluted PTFE

Femmina girevole a pressare SMS per tubo coarugato PTFE

DN	ROSCA THREAD	REFERENCIA PART N°	€
1"	40x1/6	ZRA5004016	
1" 1/4	48x1/6	ZRA5004820	
1" 1/2	60x1/6	ZRA5006024	
2"	70x1/6	ZRA5007032	

Machos SMS para Teflón
coarugado

Raccord mâle SMS Teflon convoluté

Fixed male SMS convoluted PTFE hose

Maschio fisso SMS per tubo coarugato PTFE

DN	ROSCA THREAD	REFERENCIA PART N°	€
1"	40x1/6	ZRA5124016	
1" 1/4	48x1/6	ZRA5124820	
1" 1/2	60x1/6	ZRA5126024	
2"	70x1/6	ZRA5127032	

Machos fijos SMS

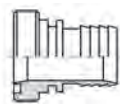

Raccord mâle SMS

Fixed male SMS

Maschio fisso SMS

DN	ROSCA THREAD	REFERENCIA PART N°	€
25	40x1/6	ZRA2124025	
32	48x1/6	ZRA2124832	
38	60x1/6	ZRA2126038	
40	60x1/6	ZRA2126040	
50	70x1/6	ZRA2127050	
65	85x1/6	ZRA2128565	
70	98x1/6	ZRA2129870	
75	98x1/6	ZRA2129875	
80	98x1/6	ZRA2129880	
100	125x1/4	ZRA212125100	
100	132x1/4	ZRA212132100	

Cono soldable SMS



Douilles à souder SMS

Liner to weld SMS

Sede a saldare per femmina SMS

DN	REFERENCIA PART N°	€
25	ZSMS S 25	
32	ZSMS S 32	
38	ZSMS S 38	
51	ZSMS S 51	
63	ZSMS S 63	
76	ZSMS S 76	
104	ZSMS S 104	

Tuercas SMS



Écrou SMS

Nuts SMS

Dadi SMS

DN	ROSCA THREAD	REFERENCIA PART N°	€
25	40x1/6	ZSMS H 25	
32	48x1/6	ZSMS H 32	
38	60x1/6	ZSMS H 38	
51	70x1/6	ZSMS H 51	
63	85x1/6	ZSMS H 63	
76	98x1/6	ZSMS H 76	
104	125x1/4	ZSMS H 104	
104	132x1/4	ZSMS H 105	

Macho soldable SMS



Nez à souder SMS

Weld male SMS

Maschio a saldare SMS

DN	ROSCA THREAD	REFERENCIA PART N°	€
25	40x1/6	ZSMS M 25	
32	48x1/6	ZSMS M 32	
38	60x1/6	ZSMS M 38	
51	70x1/6	ZSMS M 51	
63	85x1/6	ZSMS M 63	
76	98x1/6	ZSMS M 76	
104	125x1/4	ZSMS M 104	

Junta SMS silicona



Joint silicone pour SMS

Silicone joint for SMS

Guarnizione in silicone per SMS

DN	REFERENCIA PART N°	€
25	JSMSS 25	
32	JSMSS 32	
38	JSMSS 38	
50/51	JSMSS 51	
63/65	JSMSS 63	
75/76	JSMSS 76	
100/104	JSMSS 104	

Juntas SMS Teflón



Joint PTFE pour SMS

PTFE Joint for SMS

Guarnizione in PTFE per SMS

DN	REFERENCIA PART N°	€
25	JSMSP 25	
32	JSMSP 32	
38	JSMSP 38	
51	JSMSP 51	
63	JSMSP 63	
76	JSMSP 76	

Tri-Clamp ISO 2852



Raccord Tri-Clamp ISO 2852

Tri-Clamp ISO 2852

Tri-Clamp ISO 2852 per tubo flessibile

DN	Ø	REFERENCIA PART N°	€
DN 12	25	ZTC2512	
DN12	34	ZTC3412	
DN19	34	ZTC3419	
DN19	50	ZTC5019	
DN25	50	ZTC5025	
DN32	50	ZTC5032	
DN38	50	ZTC5038	
DN40	50	ZTC5040	
DN38	64	ZTC6438	
DN40	64	ZTC6440	
DN50	64	ZTC6450	
DN65	91	ZTC9165	

Tri-Clamp para soldar en tubo



Raccord Tri-Clamp a souder pour tube

Welding Tri-Clamp for pipe

Tri-Clamp a saldare per tubo rigido

DN	Ø	REFERENCIA PART N°	€
DN12	25	ZC25-12	
DN12	34	ZC34-12	
DN18	34	ZC34-18	
DN18	50.5	ZC50-18	
DN25	50.5	ZC50-25	
DN33.7	50.5	ZC50-33.7	
DN38	50.5	ZC50-38	
DN38	64	ZC64-38	
DN51	64	ZC64-51	
DN65	91	ZC91-65	

Hembra giratoria DIN 11851

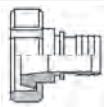

Raccord femelle tournante DIN 11851

Swivel female DIN 11851

Femmina girevole DIN 11851

DN	ROSCA THREAD	REFERENCIA PART N°	€
20	44x1/6	ZRA1004420	
25	52x1/6	ZRA1005225	
32	58x1/6	ZRA1005832	
38	65x1/6	ZRA1006538	
40	65x1/6	ZRA1006540	
50	78x1/6	ZRA1007850	
63	95x1/6	ZRA1009563	
65	95x1/6	ZRA1009565	
80	110x1/4	ZRA10011080	
100	130x1/4	ZRA100130100	

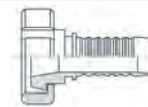
Hembra giratoria DIN 11851
para teflón coarugado

Raccord femelle tournante DIN 11851 Teflon convoluté

Swivel female DIN 11851 convoluted PTFE hose

Femmina girevole DIN 11851 per tubo corrugato PTFE

DN	ROSCA THREAD	REFERENCIA PART N°	€
1"	52x1/6	ZRA4005216	
1" 1/4	58x1/6	ZRA4005820	
1" 1/2	65x1/6	ZRA4006524	
2"	78x1/6	ZRA4007832	

Machos DIN 11851 para
teflón coarugado

Raccord mâle DIN 11851 Teflon convoluté

Fixed male DIN 11851 convoluted PTFE hose

Maschio fisso DIN 11851 per tubo corrugato PTFE

DN	ROSCA THREAD	REFERENCIA PART N°	€
1"	52x1/6	ZRA4125216	
1" 1/4	58x1/6	ZRA4125820	
1" 1/2	65x1/6	ZRA4126524	
2"	78x1/6	ZRA4127832	

Macho fijo DIN 11851

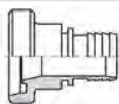

Raccord mâle DIN 11851

Fixed mâle DIN 11851

Maschio fisso DIN 11851

DN	ROSCA THREAD	REFERENCIA PART N°	€
25	52x1/6	ZRA1125225	
32	58x1/6	ZRA1125832	
38	65x1/6	ZRA1126538	
40	65x1/6	ZRA1126540	
50	78x1/6	ZRA1127850	
65	95x1/6	ZRA1129565	
75	110x1/4	ZRA11211080	
100	130x1/4	ZRA112130100	

Cono soldable DIN 11851



Douilles à souder DIN 11851

Liner to weld DIN 11851

Ogiva a saldare per dado DIN 11851

DN	REFERENCIA PART N°	€
16	ZDIN S 16	
20	ZDIN S 20	
25	ZDIN S 25	
32	ZDIN S 32	
40	ZDIN S 40	
50	ZDIN S 50	
65	ZDIN S 65	
75/80	ZDIN S 80	
100	ZDIN S 100	

Tuercas DIN 11851



Écroux DIN 11851

Nuts DIN 11851

Dado DIN 11851

DN	ROSCA THREAD	REFERENCIA PART N°	€
16	34x1/8	ZDIN H 16	
20	44x1/6	ZDIN H 20	
25	52x1/6	ZDIN H 25	
32	58x1/6	ZDIN H 32	
40	65x1/6	ZDIN H 40	
50	78x1/6	ZDIN H 50	
65	95x1/6	ZDIN H 65	
80	110x1/4	ZDIN H 80	
100	130x1/4	ZDIN H 100	

Macho soldable DIN 11851



Nez à souder DIN 11851

Weld male DIN 11851

Maschio a saldare DIN 11851

DN	ROSCA THREAD	REFERENCIA PART N°	€
16	34x1/8	ZDIN M 16	
20	44x1/6	ZDIN M 20	
25	52x1/6	ZDIN M 25	
32	58x1/6	ZDIN M 32	
40	65x1/6	ZDIN M 40	
50	78x1/6	ZDIN M 50	
65	95x1/6	ZDIN M 65	
75/80	110x1/4	ZDIN M 80	
100	130x1/4	ZDIN M 100	

Junta DIN 11851 silicona

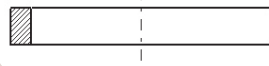

Joint silicone pour DIN 11851
Silicone joint for DIN 11851
Guarnizione in silicone per DIN 11851

DN	REFERENCIA PART N°	€
20	JDINS 20	
25	JDINS 25	
32	JDINS 32	
38/40	JDINS 40	
50	JDINS 50	
65	JDINS 65	
80	JDINS 80	
100	JDINS 100	

Junta DIN 11851 teflón



Joint PTFE pour DIN 11851
PTFE Joint for DIN 11851
Guarnizione in PTFE per DIN 11851

DN	REFERENCIA PART N°	€
20	JDINP 20	
25	JDINP 25	
32	JDINP 32	
40	JDINP 40	
50	JDINP 50	
65	JDINP 65	
80	JDINP 80	

Hembra giratoria Macon



Raccord femelle tournante Macon
Swivel female Macon
Femmina girevole Macon

DN	ROSCA THREAD	REFERENCIA PART N°	€
38	55x3	ZRA3005538	
40	55x3	ZRA3005540	
50	67x3	ZRA3006750	
65	79x3.5	ZRA3007965	
65	90x3.5	ZRA3009065	
70	90x3.5	ZRA3009070	
80	90x3.5	ZRA3009080	
80	102x4	ZRA30010280	
100	125x4	ZRA300125100	

Macho fijo Macon

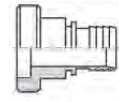

Raccord mâle fixe Macon
Male fixe Macon
Maschio fisso Macon

DN	ROSCA THREAD	REFERENCIA PART N°	€
38	55x3	ZRA3125538	
40	55x3	ZRA3125540	
50	67x3	ZRA3126750	
65	79x3.5	ZRA3127965	
65	90x3.5	ZRA3129065	
70	90x3.5	ZRA3129070	
75	90x3.5	ZRA3129080	
80	102x4	ZRA31210280	
100	125x4	ZRA312125100	

Tuercas Macon



Écrou à crans Macon
Macon nuts
Dadi Macon

DN	ROSCA THREAD	REFERENCIA PART N°	€
40	55x3	ZMAC H 40	
50	67x3	ZMAC H 50	
60	79x3.5	ZMAC H 60	
70	90x3.5	ZMAC H 70	
80	102x4	ZMAC H 80	
100	125x4	ZMAC H 100	

Camlock AISI 316 - DIN 2828

Raccords Camlock AISI 316 - DIN 2828

Camlock AISI 316 - DIN 2828

Camlock AISI 316 - DIN 2828

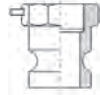
Adaptador macho - rosca
hembra Tipo A

Adapteur mâle - filetage femelle Type A

Adaptor, female threaded Type A

Adattatore maschio-filettatura femmina Tipo A

DN	ROSCA THREAD	REFERENCIA PART N°	€
12	1/2"	ZA012	
20	1/2"	ZA015	
20	3/4"	ZA020	
25	1"	ZA025	
32	1"1/4	ZA032	
40	1"1/2	ZA040	
50	2"	ZA050	
65	2"1/2	ZA065	
80	3"	ZA080	
100	4"	ZA100	

Adaptator hembra Tipo D



Adapteur femelle Type D

Coupling, female threaded Type D

Adattatore femmina Tipo D (filettatura conica)

DN	ROSCA THREAD	REFERENCIA PART N°	€
12	1/2"	ZD012	
20	1/2"	ZD015	
20	3/4"	ZD020	
25	1"	ZD025	
32	1"1/4	ZD032	
40	1"1/2	ZD040	
50	2"	ZD050	
65	2"1/2	ZD065	
80	3"	ZD080	
100	4"	ZD100	

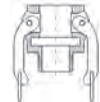
Adaptador hembra - rosca
macho Tipo B

Adapteur femelle - filetage mâle Type B

Coupling, female threaded Type B

Adattatore femmina-filettatura maschio Tipo B

DN	ROSCA THREAD	REFERENCIA PART N°	€
12	1/2"	ZB012	
20	1/2"	ZB015	
20	3/4"	ZB020	
25	1"	ZB025	
32	1"1/4	ZB032	
40	1 1/2"	ZB040	
50	2"	ZB050	
65	2"1/2	ZB065	
80	3"	ZB080	
100	4"	ZB100	

Conexión macho para
manguera Tipo E

Coupleur mâle Type E

Adaptor, with serrated hose shank Type E

Adattatore con inserto per Tipo E

DN	DN	REFERENCIA PART N°	€
1/2"	12	ZE012	
1/2"	20	ZE015	
3/4"	20	ZE020	
1"	25	ZE025	
1"1/4	32	ZE032	
1"1/2	40	ZE040	
2"	50	ZE050	
2"1/2	65	ZE065	
3"	80	ZE080	
4"	100	ZE100	

Conexión hembra para
manguera Tipo C

Coupleur femelle Type C

Coupling with serrated hose shank Type C

Adattatore con inserto per tubo Tipo C

DN	DN	REFERENCIA PART N°	€
1/2"	12	ZC012	
1/2"	20	ZC015	
3/4"	20	ZC020	
1"	25	ZC025	
1"1/4	32	ZC032	
1"1/2	40	ZC040	
2"	50	ZC050	
2"1/2	65	ZC065	
3"	80	ZC080	
4"	100	ZC100	

Adaptador macho Tipo F



Adapteur mâle Type F

Adaptor, male threaded Type F

Adattatore maschio Tipo F

DN	ROSCA THREAD	REFERENCIA PART N°	€
12	1/2"	ZF012	
20	1/2"	ZF015	
20	3/4"	ZF020	
25	1"	ZF025	
32	1"1/4	ZF032	
40	1"1/2	ZF040	
50	2"	ZF050	
65	2"1/2	ZF065	
80	3"	ZF080	
100	4"	ZF100	

Camlock AISI 316 - DIN 2828

Raccords Camlock AISI 316 - DIN 2828
Camlock AISI 316 - DIN 2828
Camlock AISI 316 - DIN 2828

Tapón hembra Tipo DC



Bouchon femelle Type DC
Dust caps Type DC
Tappo di protezione Tipo DC

DN	REFERENCIA PART N°	€
12	ZDC012	
20	ZDC015	
20	ZDC020	
25	ZDC025	
32	ZDC032	
40	ZDC040	
50	ZDC050	
65	ZDC065	
80	ZDC080	
100	ZDC100	

Tapón macho tipo DP

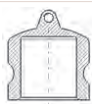

Bouchon mâle Type DP
Dust plugs Type DP
Cappuccio di protezione Tipo DP

DN	REFERENCIA PART N°	€
12	ZDP012	
20	ZDP015	
20	ZDP020	
25	ZDP025	
32	ZDP032	
40	ZDP040	
50	ZDP050	
65	ZDP065	
80	ZDP080	
100	ZDP100	

Junta Camlock NBR

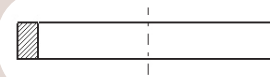

Joint Camlock NBR
Camlock NBR Seal
Guarnizione in NBR per Camlock

DN	REFERENCIA PART N°	€
12	JCAMNBR012	
15	JCAMNBR015	
20	JCAMNBR020	
25	JCAMNBR025	
32	JCAMNBR032	
40	JCAMNBR040	
50	JCAMNBR050	
65	JCAMNBR065	
80	JCAMNBR080	
100	JCAMNBR100	

Junta Camlock silicona

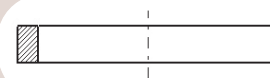

Joint Camlock silicone
Camlock silicone seal
Guarnizione in silicone per Camlock

DN	REFERENCIA PART N°	€
12	JCAMS012	
15	JCAMS015	
20	JCAMS020	
25	JCAMS025	
32	JCAMS032	
40	JCAMS040	
50	JCAMS050	
65	JCAMS065	
80	JCAMS080	
100	JCAMS100	

Crimp fittings for hoses

Pipe fittings DIN 2353

Flare fittings JIC
SAE flanges

Adaptors

Welding fittings

Industrial fittings

Several items

Racores baja presión 150 LBS AISI 304

Raccords basse pression 150 LBS AISI 304
Screwed fittings low pressure 150 LBS AISI 304
Raccordi bassa pressione 150 LBS AISI 304



Crimp fittings for hoses

Pipe fittings DIN 2353

Flare fittings JIC
SAE flanges

Adaptors

Welding fittings

Industrial fittings

Several items

Adaptador hexagonal FIG.280



Mamelon hexagonal 150 LBS FIG.280
Hexagon nipple FIG.280
Nipples esagonale FIG.280

ROSCA THREAD	REFERENCIA PART N°	€
1/4"	ZFIG28004	
3/8"	ZFIG28006	
1/2"	ZFIG28008	
3/4"	ZFIG28012	
1"	ZFIG28016	
1"1/4	ZFIG28020	
1"1/2	ZFIG28024	
2"	ZFIG28032	
2"1/2	ZFIG28040	
3"	ZFIG28048	
4"	ZFIG28060	

Tapón hembra hexagonal FIG.300



Bouchon femelle hexagonal 150 LBS FIG.300
Hexagon female cap FIG.300
Tappo femmina esagonale FIG.300

ROSCA THREAD	REFERENCIA PART N°	€
1/8"	ZFIG30002	
1/4"	ZFIG30004	
3/8"	ZFIG30006	
1/2"	ZFIG30008	
3/4"	ZFIG30012	
1"	ZFIG30016	
1"1/4	ZFIG30020	
1"1/2	ZFIG30024	
2"	ZFIG30032	
2"1/2	ZFIG30040	
3"	ZFIG30048	
4"	ZFIG30060	

Tapón hembra redondo FIG.301

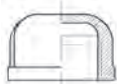

Bouchon femelle ronde 150 LBS FIG.301
Round female cap FIG.301
Tappo femmina rotondo FIG.301

ROSCA THREAD	REFERENCIA PART N°	€
1/8"	ZFIG30102	
1/4"	ZFIG30104	
3/8"	ZFIG30106	
1/2"	ZFIG30108	
3/4"	ZFIG30112	
1"	ZFIG30116	
1"1/4	ZFIG30120	
1"1/2	ZFIG30124	
2"	ZFIG30132	
2"1/2	ZFIG30140	
3"	ZFIG30148	
4"	ZFIG30160	

Reducción hembra-hembra FIG.240



Réduction 150 LBS FIG.240
Reducer socket FIG.240
Riduzione femmina-femmina FIG.240

ROSCA THREAD	REFERENCIA PART N°	€
1/4"	1/8"	ZFIG2400402
3/8"	1/4"	ZFIG2400604
1/2"	3/8"	ZFIG2400806
3/4"	1/2"	ZFIG2401208
1"	3/4"	ZFIG2401612
1"1/4	1"	ZFIG2402016
1"1/2	1"1/4	ZFIG2402420
2"	1"1/2	ZFIG2403224
2"1/2	2"	ZFIG2404032
3"	2"1/2	ZFIG2404840
4"	2"	ZFIG2406032

Adaptador hembra BSP DIN 2986 FIG.270



Manchon femelle gaz DIN 2986 150 LBS FIG.270
BSP Female coupling DIN 2986 FIG.270
Adattatore femmina BSP DIN 2986 FIG.270

ROSCA THREAD	REFERENCIA PART N°	€
1/4"	ZFIG27004	
3/8"	ZFIG27006	
1/2"	ZFIG27008	
3/4"	ZFIG27012	
1"	ZFIG27016	
1"1/4	ZFIG27020	
1"1/2	ZFIG27024	
2"	ZFIG27032	
2"1/2	ZFIG27040	
3"	ZFIG27048	
4"	ZFIG27060	

Reductor macho-hembra FIG.241



Réduction 150 LBS MG - FG FIG.241
Male-female reducer FIG.241
Riduzione maschio-femmina FIG.241

ROSCA THREAD	REFERENCIA PART N°	€
1/8"	1/4"	ZFIG2410204
1/4"	3/8"	ZFIG2410406
1/4"	1/2"	ZFIG2410408
3/8"	1/2"	ZFIG2410608
1/2"	3/4"	ZFIG2410812
3/4"	1"	ZFIG2411216
1"	1"1/4	ZFIG2411620
1"1/4	1"1/2	ZFIG2412024
1"1/2	2"	ZFIG2412432
2"	2"1/2	ZFIG2413240
2"1/2	3"	ZFIG2414048
3"	4"	ZFIG2414860

Racores baja presión 150 LBS AISI 304

Raccords basse pression 150 LBS AISI 304
Screwed fittings low pressure 150 LBS AISI 304
Raccordi bassa pressione 150 LBS AISI 304

Codo 90° hembra-hembra FIG.090



Coude 90° 150 LBS femelle gaz FIG.090
Female-female elbow 90° FIG.090
Curva 90° femmina-femmina FIG.090

ROSCA THREAD	REFERENCIA PART N°	€
1/8"	ZFIG09002	
1/4"	ZFIG09004	
3/8"	ZFIG09006	
1/2"	ZFIG09008	
3/4"	ZFIG09012	
1"	ZFIG09016	
1"1/4	ZFIG09020	
1"1/2	ZFIG09024	
2"	ZFIG09032	
2"1/2	ZFIG09040	
3"	ZFIG09048	
4"	ZFIG09060	

TE hembra-hembra-hembra FIG.130



TÉS 150 LBS FG - FG - FG FIG.130
F - F - F TEES FIG.130
Adattatore a T F - F - F

ROSCA THREAD	REFERENCIA PART N°	€
1/8"	ZFIG13002	
1/4"	ZFIG13004	
3/8"	ZFIG13006	
1/2"	ZFIG13008	
3/4"	ZFIG13012	
1"	ZFIG13016	
1"1/4	ZFIG13020	
1"1/2	ZFIG13024	
2"	ZFIG13032	
2"1/2	ZFIG13040	
3"	ZFIG13048	
4"	ZFIG13060	

Codo 45° hembra-hembra FIG.120



Coude 45° 150 LBS FG - FG FIG.120
Female-female elbow 45° FIG.120
Adattatore a 45° femmina-femmina

ROSCA THREAD	REFERENCIA PART N°	€
1/8"	ZFIG12002	
1/4"	ZFIG12004	
3/8"	ZFIG12006	
1/2"	ZFIG12008	
3/4"	ZFIG12012	
1"	ZFIG12016	
1"1/4	ZFIG12020	
1"1/2	ZFIG12024	
2"	ZFIG12032	
2"1/2	ZFIG12040	
3"	ZFIG12048	
4"	ZFIG12060	

Codo 90° macho-hembra FIG.092

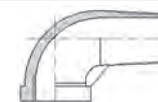

Coude 90° 150 LBS MG - FG FIG.092
Male-female elbow 90° FIG.092
Adattatore a 90° maschio-femmina FIG.092

ROSCA THREAD	REFERENCIA PART N°	€
1/8"	ZFIG09202	
1/4"	ZFIG09204	
3/8"	ZFIG09206	
1/2"	ZFIG09208	
3/4"	ZFIG09212	
1"	ZFIG09216	
1"1/4	ZFIG09220	
1"1/2	ZFIG09224	
2"	ZFIG09232	
2"1/2	ZFIG09240	
3"	ZFIG09248	
4"	ZFIG09260	

Unión hembra-hembra FIG.340



Raccord 3 pièces 150 LBS FG - FG FIG.340
Female-female FIG.340
Unione femmina-femmina FIG.340

ROSCA THREAD	REFERENCIA PART N°	€
1/8"	ZFIG34002	
1/4"	ZFIG34004	
3/8"	ZFIG34006	
1/2"	ZFIG34008	
3/4"	ZFIG34012	
1"	ZFIG34016	
1"1/4	ZFIG34020	
1"1/2	ZFIG34024	
2"	ZFIG34032	
2"1/2	ZFIG34040	
3"	ZFIG34048	
4"	ZFIG34060	

Unión macho-hembra FIG.341



Raccord 3 pièces 150 LBS MG - FG FIG.341
Male-female union FIG.341
Unione maschio-femmina FIG.341

ROSCA THREAD	REFERENCIA PART N°	€
1/4"	ZFIG34104	
3/8"	ZFIG34106	
1/2"	ZFIG34108	
3/4"	ZFIG34112	
1"	ZFIG34116	
1"1/4	ZFIG34120	
1"1/2	ZFIG34124	
2"	ZFIG34132	
2"1/2	ZFIG34140	
3"	ZFIG34148	
4"	ZFIG34160	

Racores baja presión 150 LBS AISI 304

Raccords basse pression 150 LBS AISI 304
Screwed fittings low pressure 150 LBS AISI 304
Raccordi bassa pressione 150 LBS AISI 304

Tapón macho hexagonal FIG.290



Bouchon mâle 150 LBS tête hexagonale FIG.290

Hexagon male plug FIG.290

Tappo maschio esagonale FIG.290

ROSCA THREAD	REFERENCIA PART N°	€
1/8"	ZFIG29002	
1/4"	ZFIG29004	
3/8"	ZFIG29006	
1/2"	ZFIG29008	
3/4"	ZFIG29012	
1"	ZFIG29016	
1"1/4	ZFIG29020	
1"1/2	ZFIG29024	
2"	ZFIG29032	
2"1/2	ZFIG29040	
3"	ZFIG29048	
4"	ZFIG29060	

Tapón macho cuadrado FIG.291



Bouchon mâle 150 LBS tête carrée FIG.291

Male square plug FIG.291

Tappo maschio testa quadrata FIG.291

ROSCA THREAD	REFERENCIA PART N°	€
1/8"	ZFIG29102	
1/4"	ZFIG29104	
3/8"	ZFIG29106	
1/2"	ZFIG29108	
3/4"	ZFIG29112	
1"	ZFIG29116	
1"1/4	ZFIG29120	
1"1/2	ZFIG29124	
2"	ZFIG29132	
2"1/2	ZFIG29140	
3"	ZFIG29148	
4"	ZFIG29160	

Cruz roscada FIG.180



Croix égalé 150 LBS FG FIG.180

Threaded cross FIG.180

Croce filettata femmina FIG.180

ROSCA THREAD	REFERENCIA PART N°	€
1/8"	ZFIG18002	
1/4"	ZFIG18004	
3/8"	ZFIG18006	
1/2"	ZFIG18008	
3/4"	ZFIG18012	
1"	ZFIG18016	
1"1/4	ZFIG18020	
1"1/2	ZFIG18024	
2"	ZFIG18032	
2"1/2	ZFIG18040	
3"	ZFIG18048	
4"	ZFIG18060	

Válvula esfera paso total baja presión 70 Bar



Robinet basse pression 2 voies boisseau sphérique passage total 70 Bar

Ball-valve low pressure full bore 70 Bar

Rubinetto a sfera bassa pressione passaggio totale 70 Bar

DN	ROSCA THREAD	REFERENCIA PART N°	€
6	1/4" BSP	BP2V14INOX	
10	3/8" BSP	BP2V38INOX	
13	1/2" BSP	BP2V12INOX	
20	3/4" BSP	BP2V34INOX	
25	1" BSP	BP2V1INOX	
32	1"1/4 BSP	BP2V114INOX	
40	1"1/2 BSP	BP2V112INOX	
50	2" BSP	BP2V2INOX	
65	2"1/2 BSP	BP2V212INOX	
80	3" BSP	BP2V3INOX	

Válvula esfera paso total baja presión 3 piezas



Robinet basse pression 2 voies boisseau sphérique passage total 3 pcs

Ball-valve low pressure full bore 3 pcs

Rubinetto a sfera bassa pressione 3 pcs

ROSCA THREAD	REFERENCIA PART N°	€
1/4" BSP	BP2V3P14INOX	
3/8" BSP	BP2V3P38INOX	
1/2" BSP	BP2V3P12INOX	
3/4" BSP	BP2V3P34INOX	
1" BSP	BP2V3P1INOX	
1" 1/4 BSP	BP2V3P114INOX	
1" 1/2 BSP	BP2V3P112INOX	
2" BSP	BP2V3P2INOX	